

# MODULAR BUILDINGS FOR EDUCATION

## Make an Impact with Modular School Buildings

Overcrowded classrooms and outdated facilities are a common concern for educational institutions. These issues can cause a domino effect of negative impacts on students, staff, and administrators.

Incorporating modular education buildings into your growth plans allows for efficient timelines, additional, needed classroom space, and high-quality solutions.

### Portable Classrooms help solve ...

- Overcrowded Spaces
- Outdated Interiors
- Overspent Budgets

## Debunking Common Modular Myths

~~They aren't visually appealing.~~

- ↳ Portable classrooms and other modules can be customized to match your existing style and facade.

~~They aren't structurally sound.~~

- ↳ BOXX Modular structures are built to the same code and standard as their traditional counterparts.

~~They're only temporary.~~

- ↳ Although modules can be a great resource for swing spaces, they can also be constructed as a permanent structure.

## Where to Use Modules in Your Educational Facilities

For Students	For Administrators & Staff
<ul style="list-style-type: none"><li>•Classrooms</li><li>•Cafeterias</li><li>•Laboratories</li><li>•Restrooms</li><li>•Locker Rooms</li></ul>	<ul style="list-style-type: none"><li>•Management Offices</li><li>•Conference Rooms</li><li>•Community Meeting Spots</li><li>•Swing Space for New Growth</li></ul>

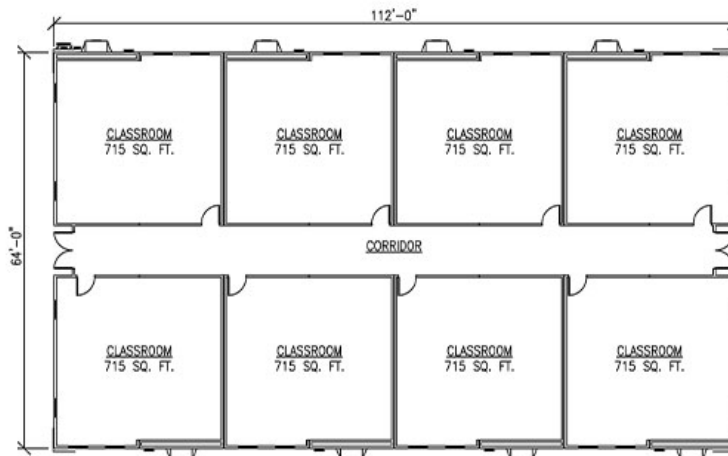

## Modular Education Buildings in Action: Moore County Schools

### The Problem

- ↳ Pinehurst Elementary, part of Moore County Schools, was originally built in the 1940s and needed some serious renovations to its facilities. The current institution couldn't keep up with the growing enrollment and student population.

### The Key Decision Factors

- ↳ Moore County Schools knew that these renovations would take up to a year and a half, and needed a space to hold all elementary classes and management offices. With limited timelines, they needed a solution that would be up and running before the beginning of the school year.

### The Modular Solution

- ↳ Using an open park field, BOXX Modular constructed 8 separate modules which encompassed 8,000 square feet. The entire complex was leased to them so everything was returned to BOXX Modular once the permanent structure was ready for use.



The campus included 50,000 square feet of classroom space, offices, a library, restrooms, and more. The entirety of this project was completed and installed in less than 3 months.