



WALK-IN & DRIVE-THRU | 2 OFFICE | 12' X 60'

MODEL# BK1260

NEW 12' x 60' Portable Bank Building

- 720 square feet
- Drive-up teller window
- Walk-in multiple teller counter
- 2 offices
- Lobby area
- Night drop
- Recessed entryway
- 2 Restrooms
- Front and rear entrances
- Programmable climate control
- High-quality exterior and interior finishes
- For lease and sale!

Stock availability may be limited and require to-be-built new construction. As-built design may vary in appearance and layout.

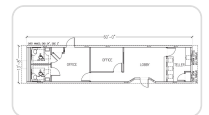
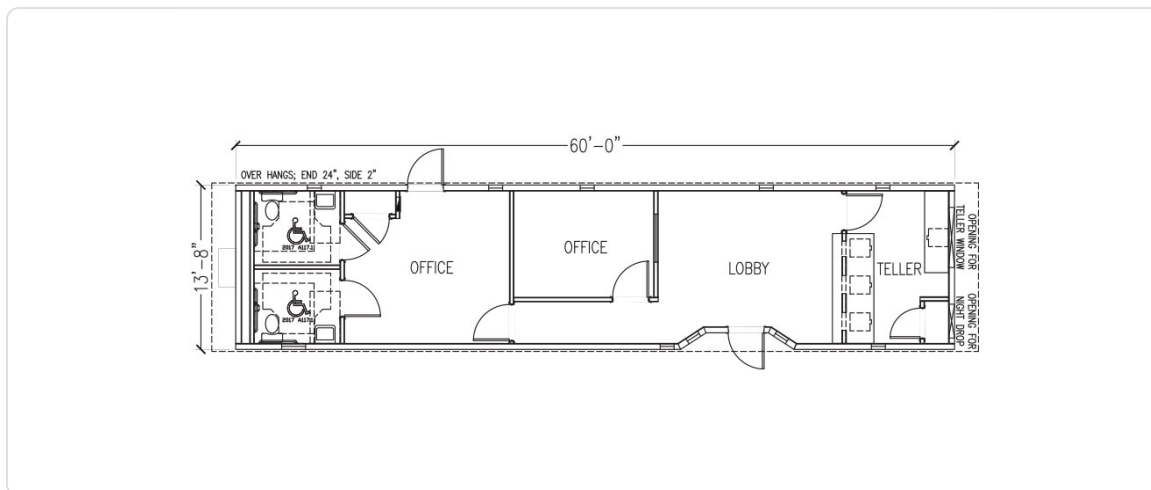

Specifications

Square Feet	720
Interior Wall Finish	VCG
HVAC Quality	1
Prefer talking on the phone? Give us a call.	2
1-877-966-7839	

Size	12' x 60'
Flooring Material	Carpet
Restrooms	2