



24' X 66' MEDICAL BUILDING

UNIT# MDC-00007

24' x 66' Medical Building Totaling 1584 Square Feet With Restroom(s)

Availability of this building is subject to change, and details may vary from what is listed.

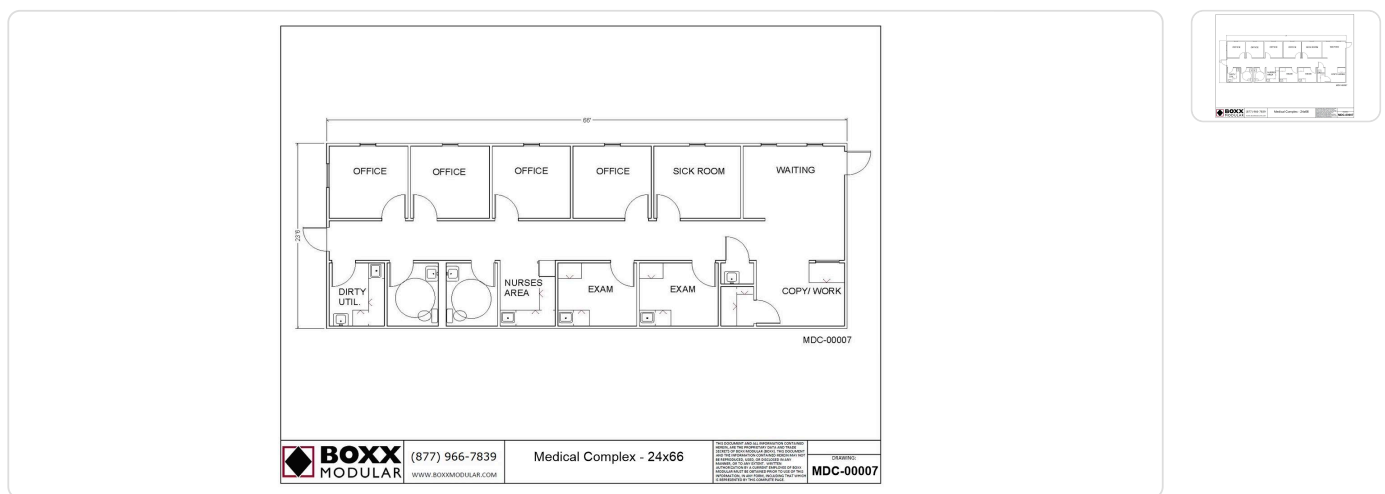

Specifications

Square Feet	1,584	Size	24' x 66'
Wind Load (mph)	80	Roof Load (psf)	60
Exterior Finish	Hard Siding	HVAC Quantity	0
Restrooms (qty)	2	Ceiling Type	Hard Ceiling

Locations available for shipping

Connecticut
Delaware

Massachusetts
Rhode Island

Prefer talking on the phone?

Give us a call.

1-877-966-7839