

## UNIT# OC-00677

Availability of this building is subject to change, and details may vary from what is listed.

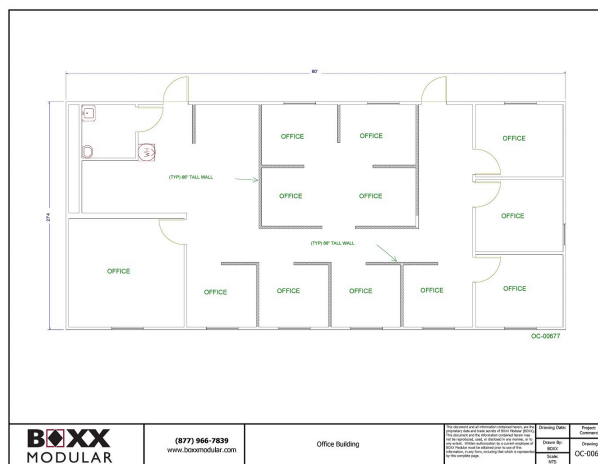

Square Feet	1,585	Size	28' x 60'
Wind Load (mph)	110	Roof Load (psf)	30
Floor Load (psf)	50	Exterior Finish	Alum .019
Roofing Material	Galvanized 30 ga.	Interior Wall Finish	VCG
Flooring Material	0	Lighting	Surface Mounted
HVAC Quantity	2	Classroom (qty)	12
Restrooms (qty)	1	Ceiling Type	Seaspray

## Georgia

Prefer talking on the phone?

Give us a call.

1-877-966-7839